

FREE STANDING / BUILT-UNDER WINE CELLAR BUW20BA

Brandt

SPECIFICATIONS

- Free standing / Built under
- Colour: Black steel frame
- Door Type: 3 layer glass(UV filter)
- Capacity: 20 Bottles (Bordeaux light)
- Temperature display: Digital
- Temperature range: 5°C - 20°C
- Refrigerating gas: R600a
- Handle type: Integrated
- Climate class: T
- Noise level: 38 dBA
- Number of zone(s): Single
- Anti-vibration: Yes
- Number of shelves: 5 (Wood)
- Light Source: LED
- Reversible door: No



**FREE STANDING / BUILT-UNDER
WINE CELLAR
BUW20BA**

Brandt

ELECTRICAL CONNECTIONS

- Maximum electric power (W): 65
- Current (A): 0.8
- Voltage (V): 220 – 240
- Frequency (Hz): 50
- Length of power supply cord (cm): 150
- Plug type: UK

DIMENSIONS

- Dimensions of product (mm): H820 x W295 x D570
- Built under dimensions (mm): >H825 x >W300 x >D575
- Dimensions of packed product (mm): H895 x W390 x D625
- Net weight (kg): 26.5
- Gross weight (kg): 30

**FREE STANDING / BUILT-UNDER
WINE CELLAR
BUW20BA**

Brandt

INSTALLATION DIAGRAM

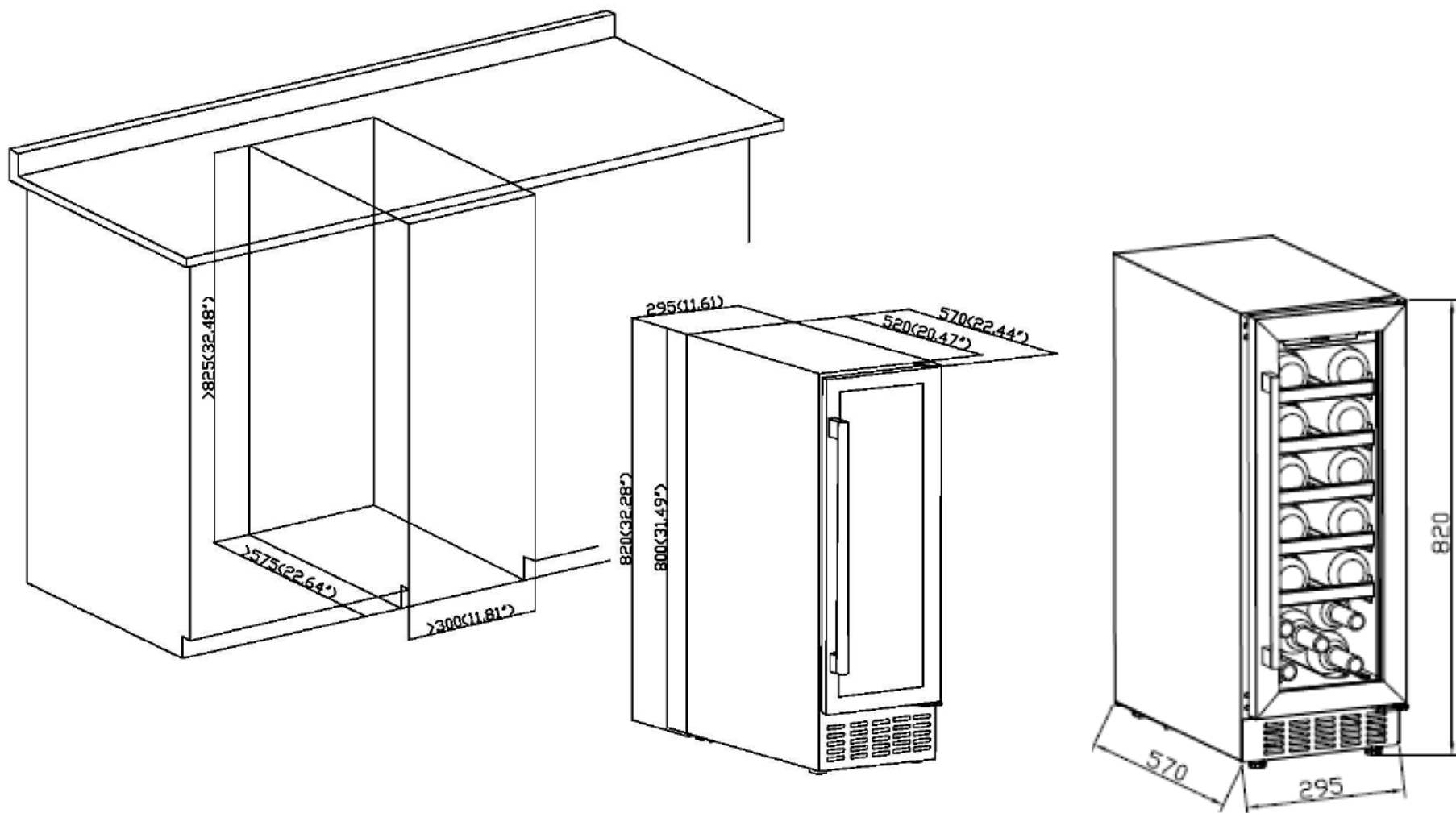

**FREE STANDING / BUILT-UNDER
WINE CELLAR
BUW20BA**

Brandt

LOADING PLANS

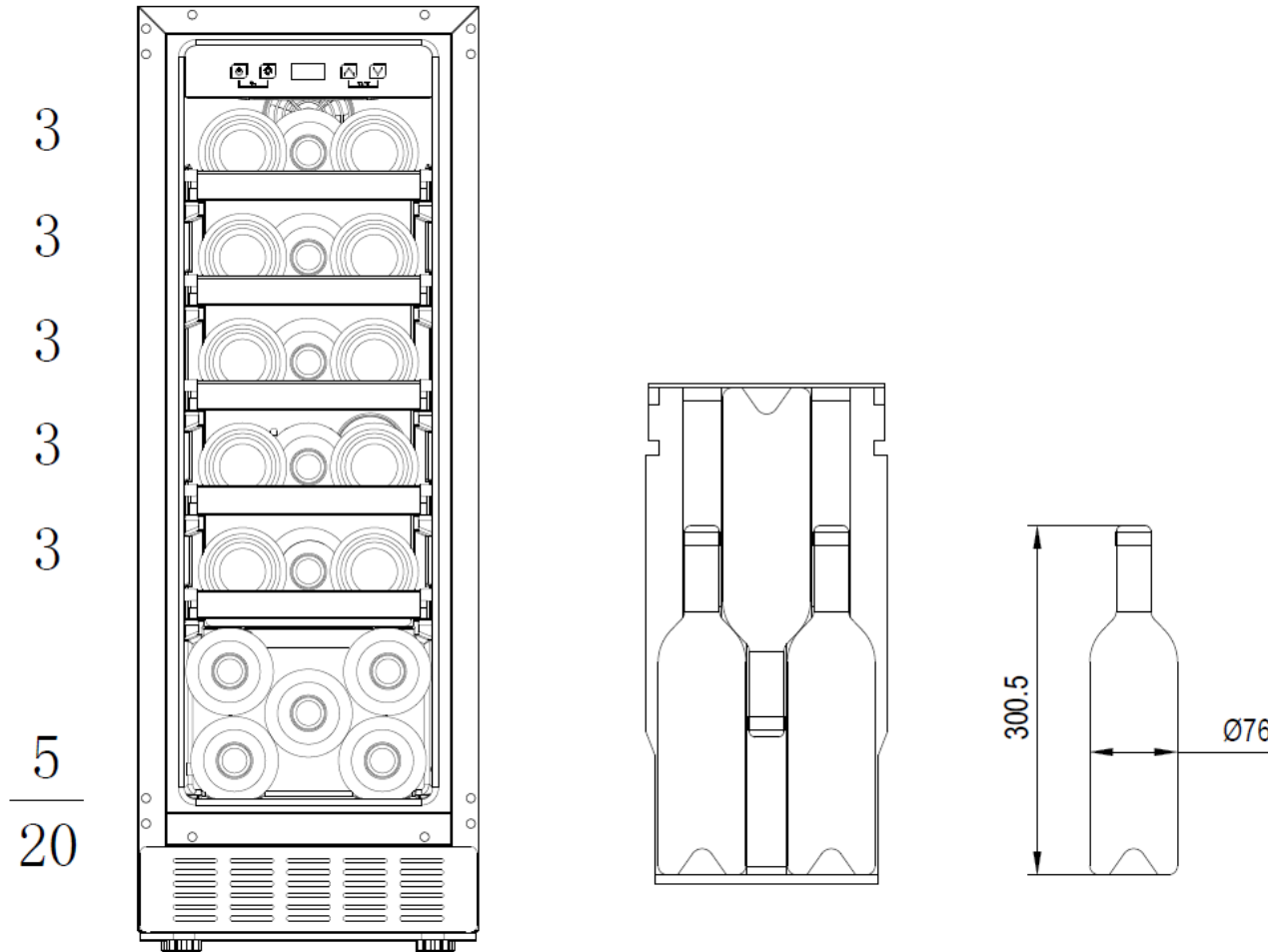

Loading plan based on traditional Bordeaux 750ml bottles