

FREE STANDING / BUILT-UNDER WINE CELLAR BUW46DBA

Brandt

SPECIFICATIONS

- Free standing / Built-under
- Colour: Black steel frame
- Door Type: Heated glass (UV filter)
- Capacity: 46 Bottles (Bordeaux light)
- Temperature display: Digital
- Temperature range: 5°C - 22°C
- Refrigerating gas: R600a
- Handle type: Integrated
- Climate class: T
- Noise level: 41 dBA
- Number of zone(s): Dual
- Anti-vibration: Yes
- Number of shelves: 5 (Wood)
- Light source: LED
- Reversible door: No



**FREE STANDING / BUILT-UNDER
WINE CELLAR
BUW46DBA**

Brandt

ELECTRICAL CONNECTIONS

- Maximum electric power (W): 70
- Current (A): 0.8
- Voltage (V): 220 – 240
- Frequency (Hz): 50
- Length of power supply cord (cm): 150
- Plug type: UK

DIMENSIONS

- Dimensions of product (mm): H820 x W595 x D570
- Built In dimension (mm): >H825 x >W605 x >D575
- Dimensions of packed product (mm): H900 x W696 x D625
- Net weight (kg): 42
- Gross weight (kg): 48

**FREE STANDING / BUILT-UNDER
WINE CELLAR
BUW46DBA**

Brandt

INSTALLATION DIAGRAM

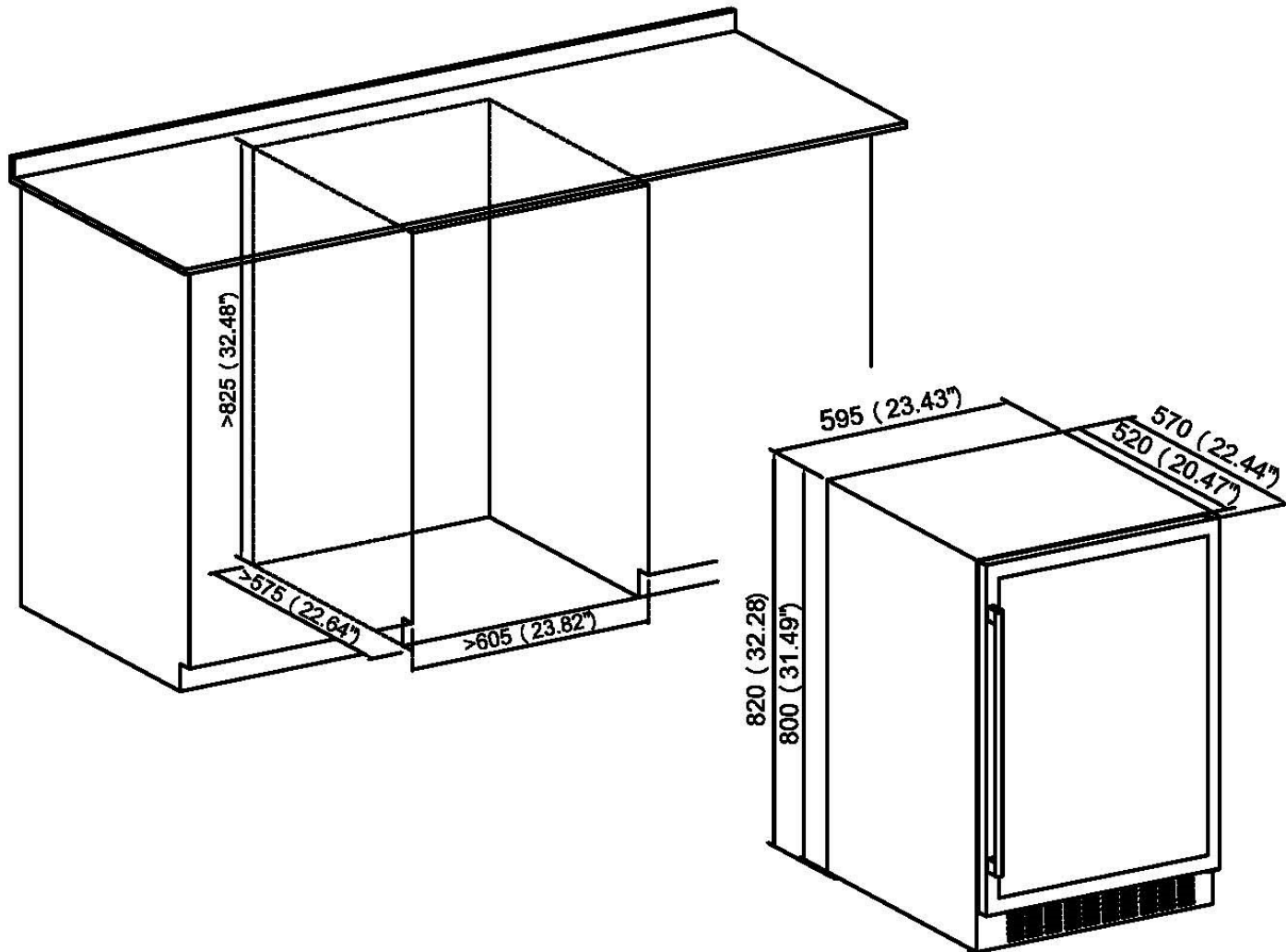

**FREE STANDING / BUILT-UNDER
WINE CELLAR
BUW46DBA**

Brandt

LOADING PLANS

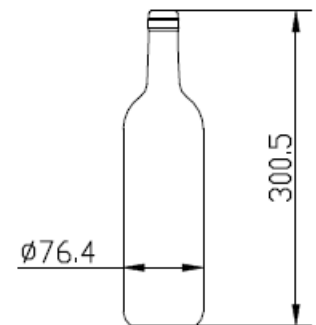
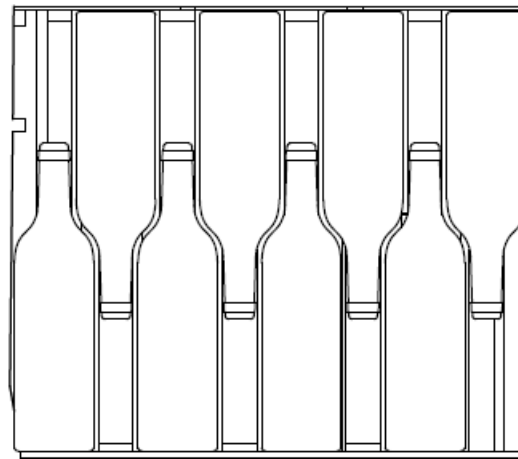
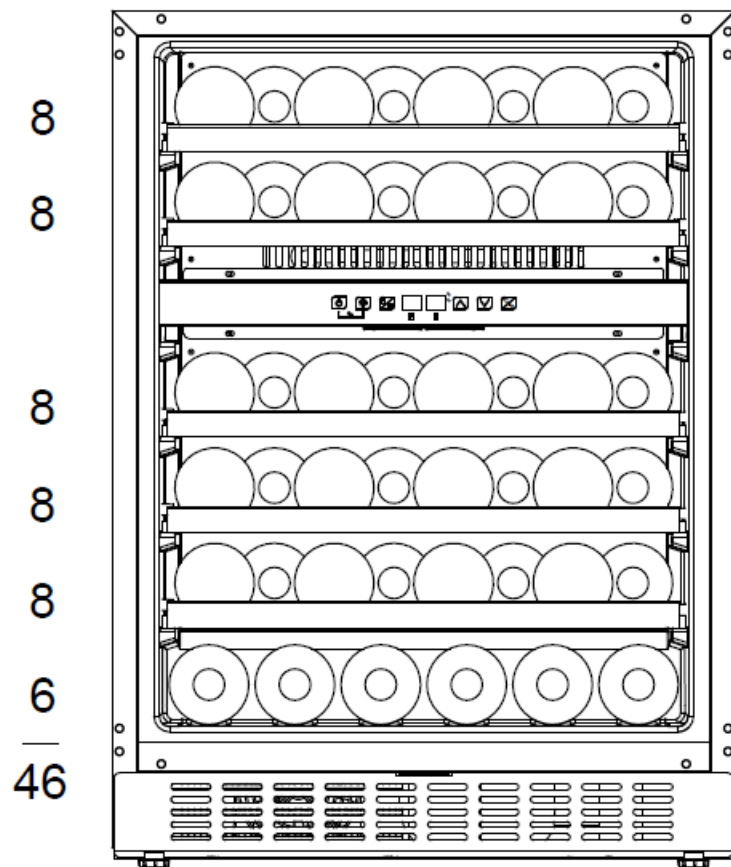

Loading plan based on traditional Bordeaux 750ml bottles